



CONCEPTUAL RENDERING  
VIEW LOOKING NORTHWEST

 **newman architecture**  
DECEMBER 15, 2011



# ST. CLETUS PARISH CENTER



CONCEPTUAL RENDERING  
VIEW LOOKING NORTHEAST

 **newman architecture**  
DECEMBER 15, 2011



# ST. CLETUS PARISH CENTER

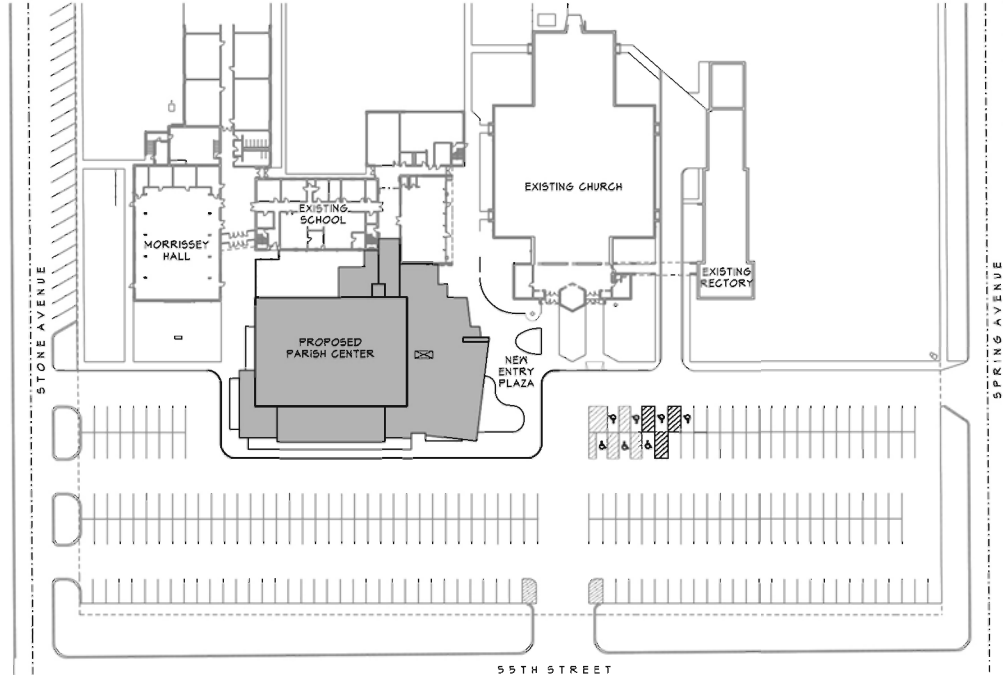

SITE PLAN

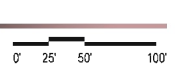

 **newman architecture**  
 DECEMBER 15, 2011



# ST. CLETUS PARISH CENTER

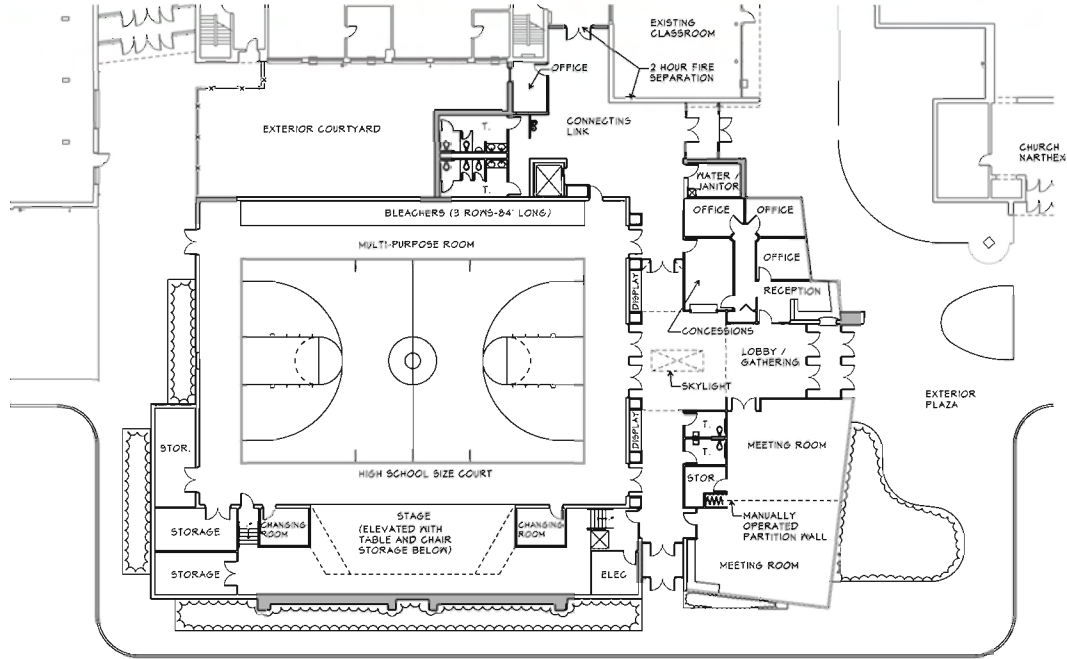

FIRST FLOOR PLAN

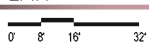

# ST. CLETUS PARISH CENTER

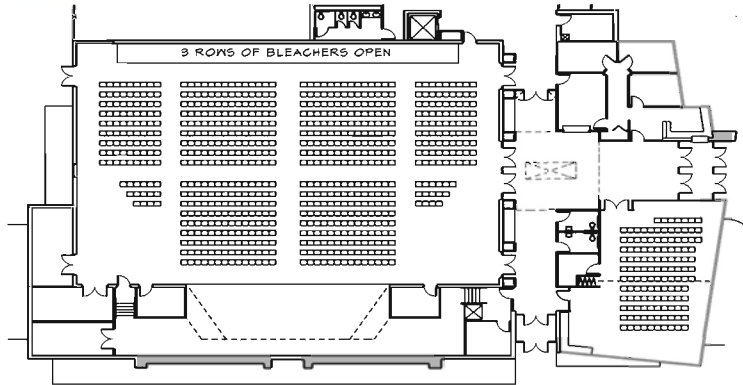

PROPOSED SEATING LAYOUTS

MEETING ROOM:

TABLES AND CHAIRS - 64 PEOPLE  
 CHAIRS ONLY - 125 PEOPLE

MULTI-PURPOSE ROOM:

ROUND TABLES AND CHAIRS - 320 PEOPLE  
 RECTANGULAR TABLES AND CHAIRS - 384 PEOPLE

BLEACHERS - 156 PEOPLE  
 CHAIRS ONLY - 646 PEOPLE  
 TOTAL: 850 PEOPLE

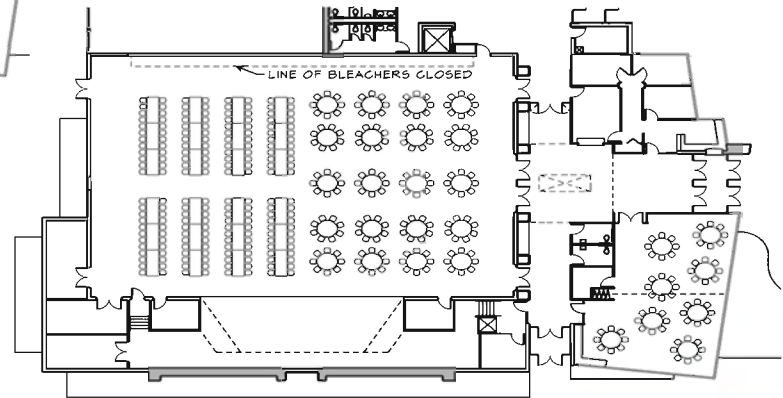

FIRST FLOOR PLAN

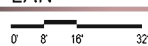

 **newman architecture**  
 DECEMBER 15, 2011



# ST. CLETUS PARISH CENTER